

COAXIAL ADAPTER

MCX-SMA Standard Series

Features

- ✓ Impedance :50ohm
- ✓ Frequency : DC-6GHz
- ✓ Delivery From Stock



Specifications

PART NUMBER	MVE1559
DESCRIPTION	MCX Male To SMA Female, Adapter, DC-6GHz
ELECTRICAL	MATERIALS
FREQUENCY : DC-6GHz IMPEDANCE: 50OHM VSWR:1.2MAX. TEMPERATURE RANGE: 65~+155°C	BODY: BRASS, GOLD 3 μ" CONTACT: BRASS, GOLD 20 μ" INSULATOR: TEFLON

TOLERANCE: X=±0.2 X.X=±0.1 X.XX=±0.05

Outline Drawing (Unit: mm)

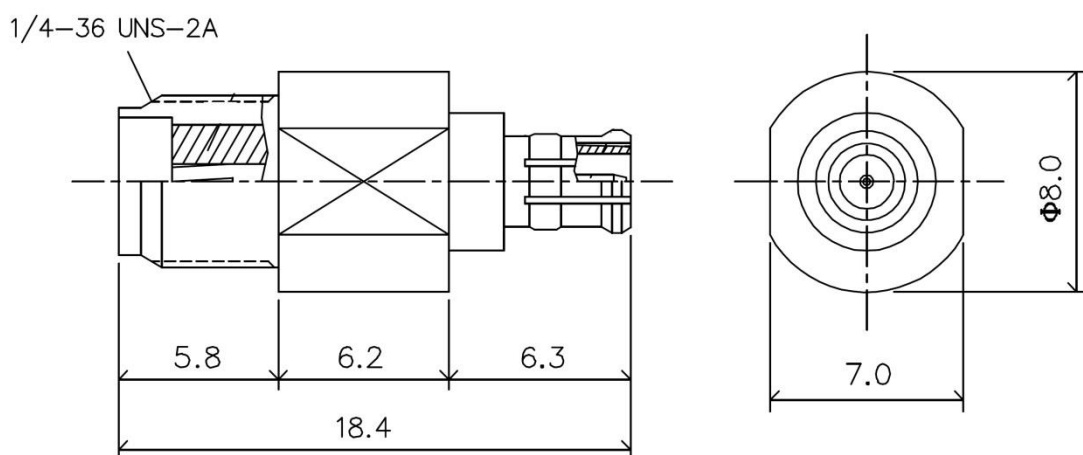

- NOTES:
1. ALL SPECIFICATIONS ARE SUBJECT TO CHANGE WITHOUT NOTICE AT ANY TIME
 2. CUSTOMER OUTLINE DRAWING FOR REFERENCE ONLY



Typical Test Result

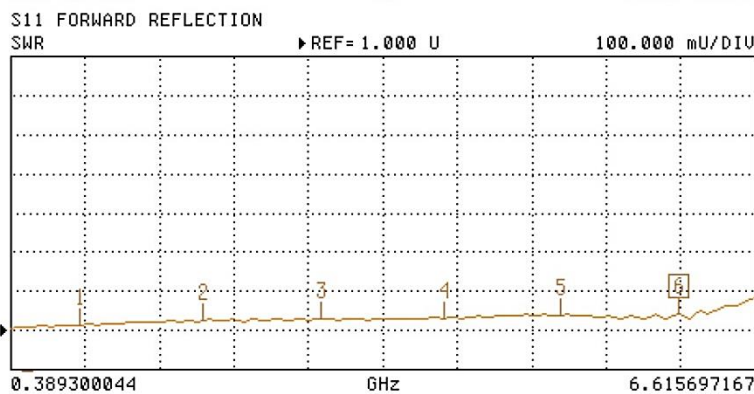
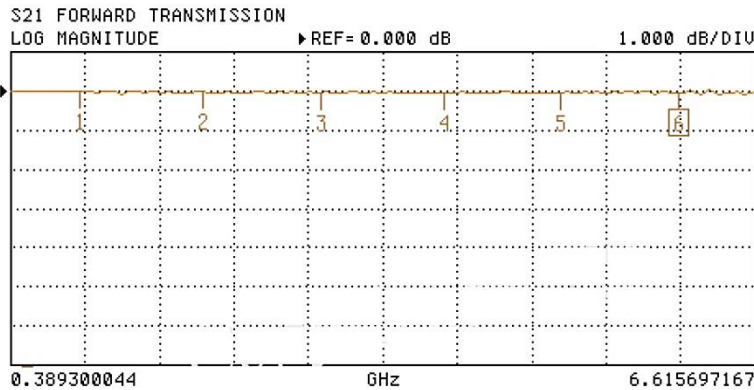

CH 3 - S11
0.0000 mm REF
0.000 dB OFFSET
0.00° OFFSET

▶ MARKER 6
5.978349430 GHz
1.040 U

MARKER TO MAX
MARKER TO MIN

- | | | |
|---|-----------------|---------|
| 1 | 0.977621032 GHz | 1.013 U |
| 2 | 2.007182761 GHz | 1.023 U |
| 3 | 2.987717741 GHz | 1.026 U |
| 4 | 4.017279470 GHz | 1.028 U |
| 5 | 4.997814450 GHz | 1.037 U |

MARKER READOUT
FUNCTIONS

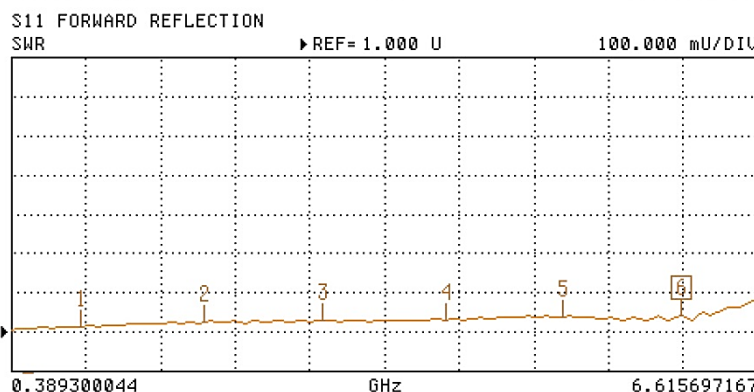
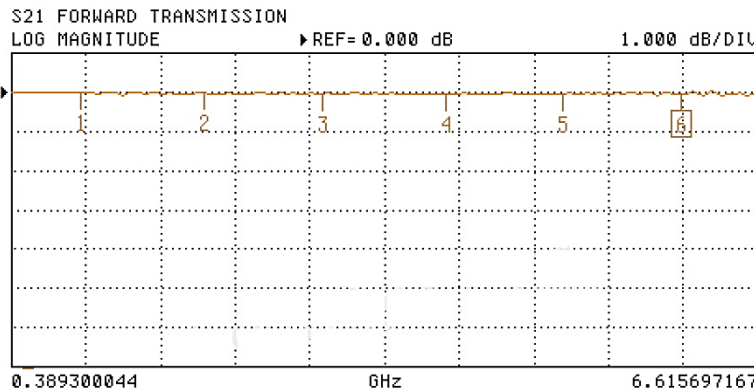

CH 3 - S11
0.0000 mm REF
0.000 dB OFFSET
0.00° OFFSET

▶ MARKER 6
5.978349430 GHz
1.040 U

MARKER TO MAX
MARKER TO MIN

- | | | |
|---|-----------------|---------|
| 1 | 0.977621032 GHz | 1.013 U |
| 2 | 2.007182761 GHz | 1.023 U |
| 3 | 2.987717741 GHz | 1.026 U |
| 4 | 4.017279470 GHz | 1.028 U |
| 5 | 4.997814450 GHz | 1.037 U |

MARKER READOUT
FUNCTIONS

NOTES:

1. ALL SPECIFICATIONS ARE SUBJECT TO CHANGE WITHOUT NOTICE AT ANY TIME
2. CUSTOMER OUTLINE DRAWING FOR REFERENCE ONLY

